

LOCATION MAP

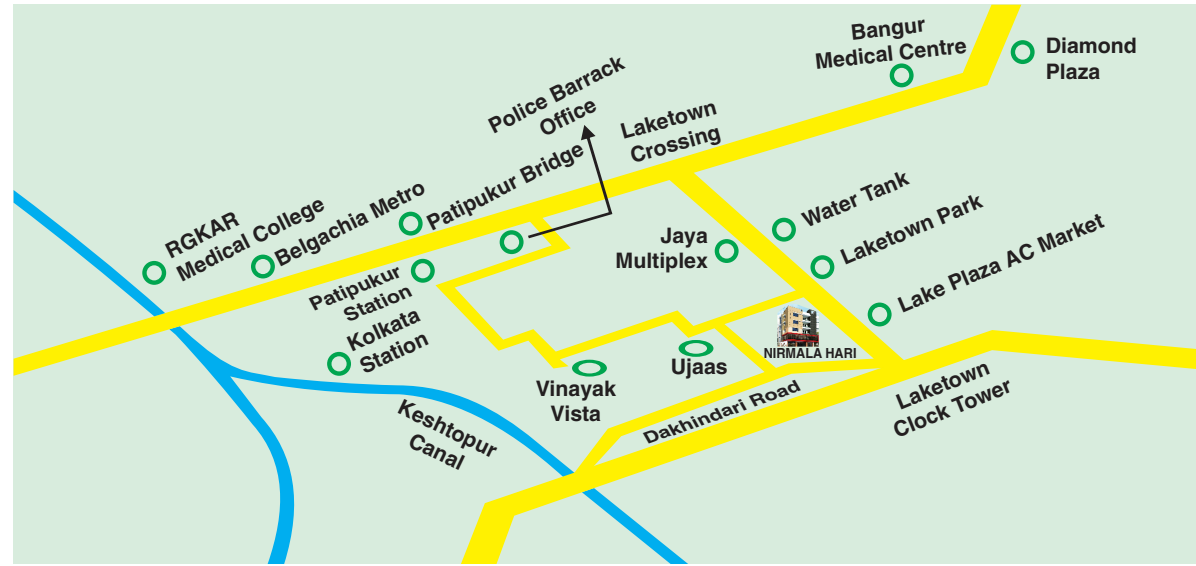

AN GROUP



Administrative Office :
AARIT INFRA DEVELOPERS
"Nirmala Vatika",
18, Golaghata Road,
Kolkata - 700 048

Architects :
Dipicon Consultants Pvt Ltd
191, Canal Street,
Kolkata - 700 001
E-Mail: cdipicon@yahoo.com

Developers
AN GROUP
"NIRMALA VATIKA"
18, GOLAGHATA ROAD, KOLKATA - 700 048.
Mob.: +91 98301 06520, +91 93307 76797
E-mail: angroup.realestate@gmail.com

Project Site:
"Nirmala Hari", P-392, S.K. Deb Road, Kolkata - 700 048

DISCLAIMER

All details in this booklet are for easy information and concept purpose only, and to not from part of the agreement. This document is tentative and developers reserve the right to make variations and modification.



AN GROUP

NIRMALA HARI



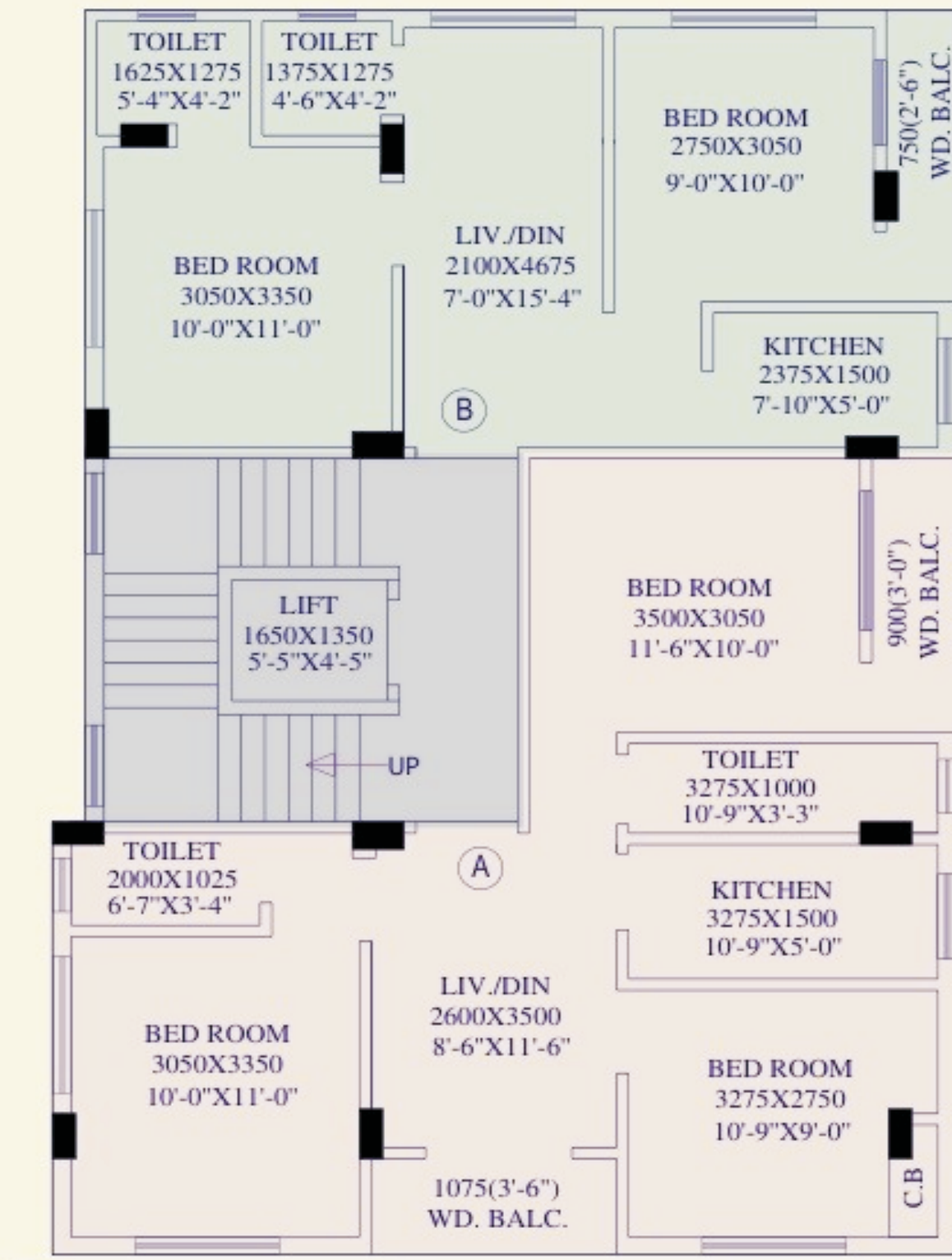

AREA STATEMENT

FLAT MKD.	FLAT TYPE	COVERED AREA	BUILT-UP AREA	SALEABLE AREA (23%)
FLAT - A	3 BHK	697 SFT.	820 SFT.	1066 SFT.
FLAT - B	2 BHK	490 SFT.	576 SFT.	749 SFT.

NIRMALA HARI

An enhanced living amidst concrete structures. 10 Distinguished units sharing the charm and ambience of NIRMALA HARI. A proficiently designed Building maintaining the quality and standard of contemporary architecture. A home away from the bustling crowd yet conveniently connected to the happening world.

THE BUILDING



Flooring: Vitrified Tiles in Bedroom, Living Room, Dining Room, Balcony & Kitchen, Toilets with Anti-Skid Tiles/Marbles.



Windows: Anodized Aluminum Section.



Balcony: Decorative with MS Railings / Glass fittings.



Kitchen: Granite / Marble Slab Counter with Stainless Steel Sink. Ceramic Tiles upto 3 Ft. height above platform.



Toilets: Tiles up to door heights, Hot & Cold-Water Point, European Style WC and basin of reputed make, Contemporary CP Fittings of Branded Quality.



Doors : Quality Flush Doors with Laminations and Fittings.



Lift: Branded.



Electric: Concealed copper wiring with latest modular switches, points of AC. TV & telephone in living Room & all Bedrooms, Power Points and Exhaust fan points in Kitchen & toilets